

# PYRAMIDS

## GENERAL CONTRACTING & TRADING AGENCIES





## CONTENTS

1

### **PART 01**

Project design scheme is introduced.

2

### **PART 02**

Introduction of furniture product scheme

3

### **PART 03**

Introduction to building structure and interior materials.

4

### **PART 04**

project case



Project design scheme is introduced.

# PART **1**





## Plan design

Surface area: 1,018.9 square feet



# Outdoor visual

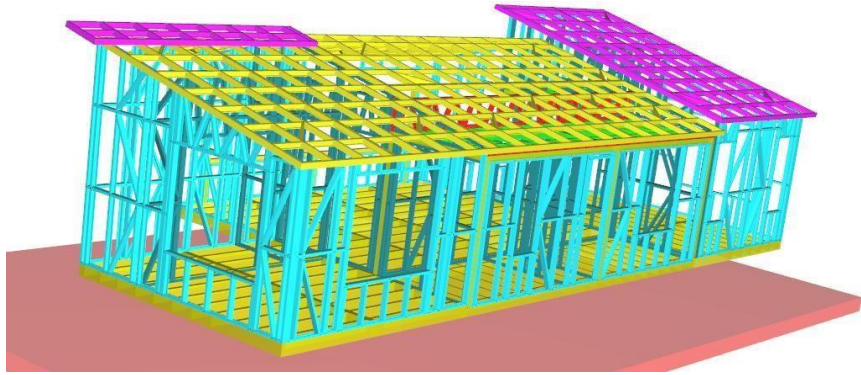



# LIVING ROOM





# MASTER BEDROOM

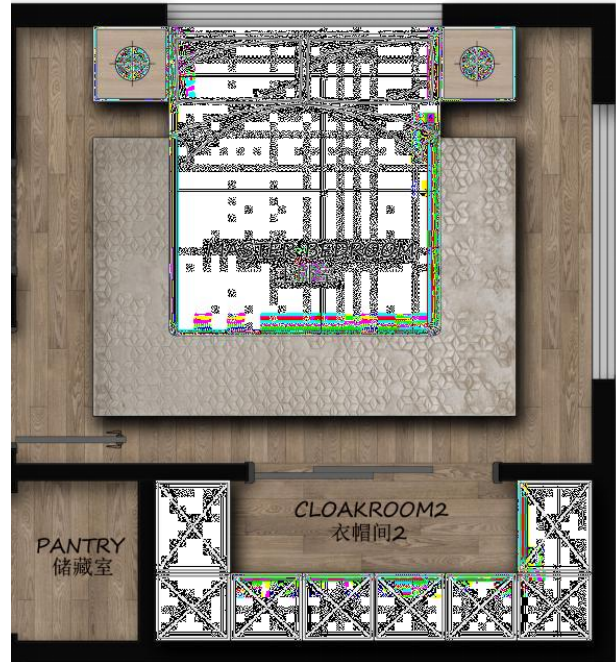



TOILET FOR MASTER  
BEDROOM

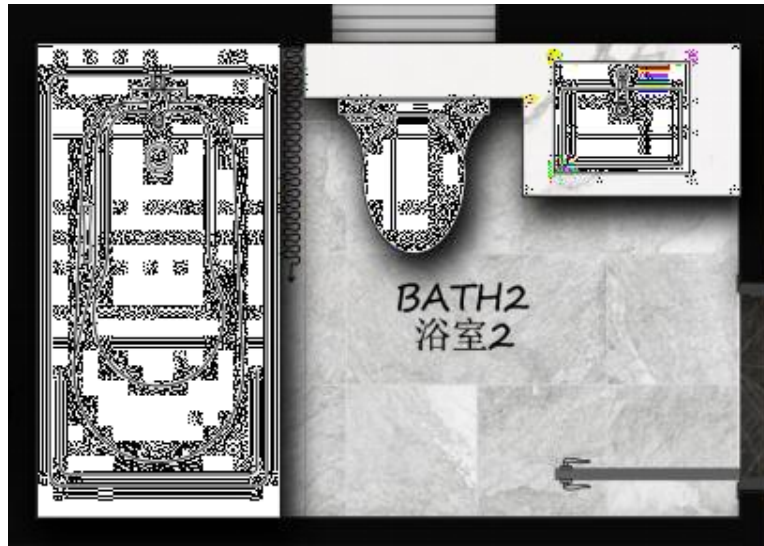



# BEDROOM2

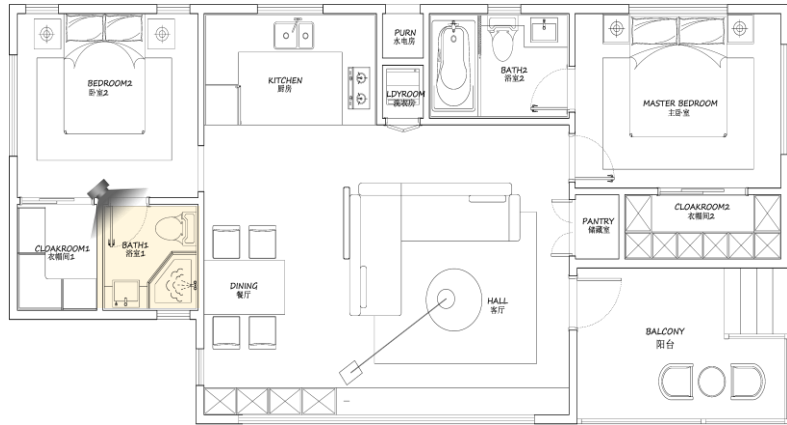



Introduction of furniture product scheme

**PART**  **2**



# LIVING ROOM

## Furniture Selection Reference

Space Material FF&E

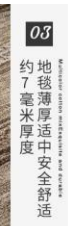
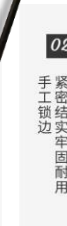
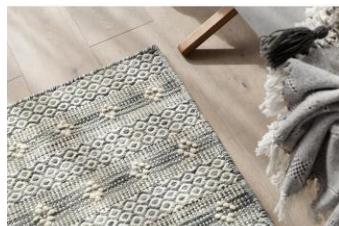

## DINING AREA

### Furniture Selection Reference

Space Material FF&E





# MASTER BEDROOM

## Furniture Selection Reference

Space Material FF&E

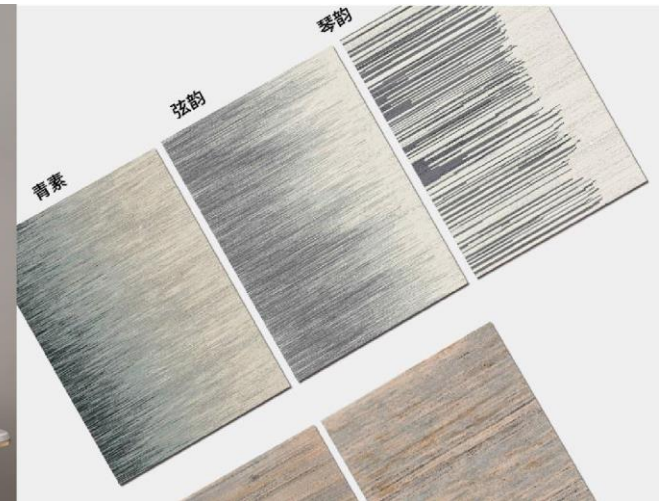
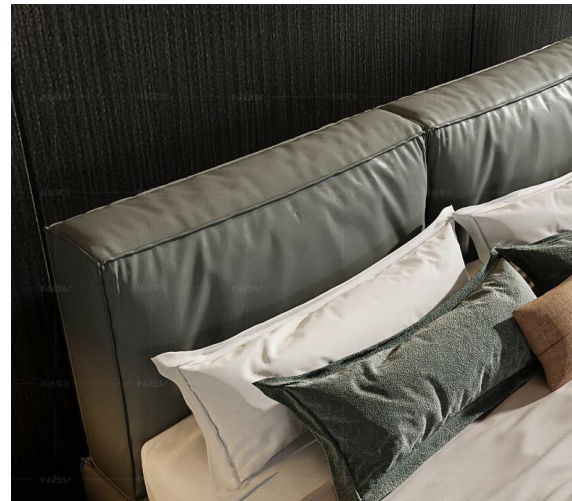

## MASTER BEDROOM

Space Material F&E

## Furniture Selection Reference

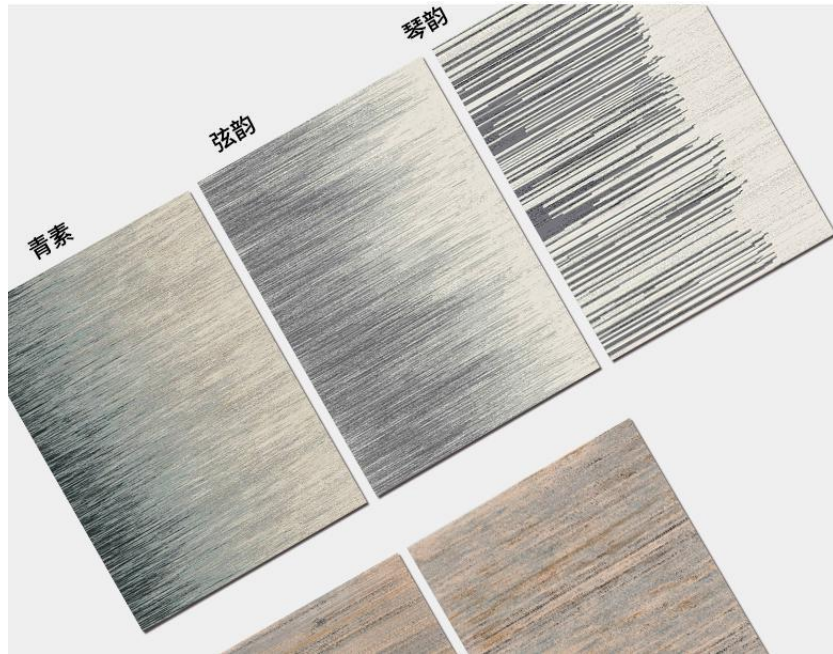



TOILET FOR MASTER  
BEDROOM

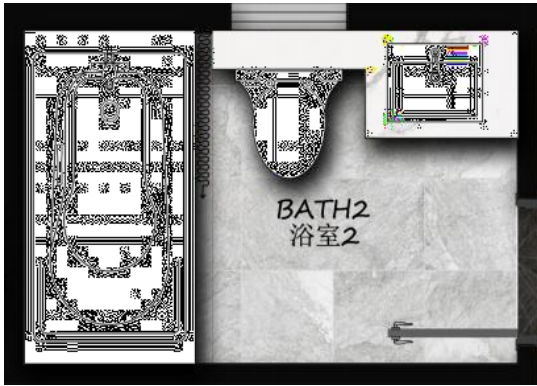

Suncoo®  
尚高卫浴



## TOILET FOR MASTER BEDROOM

### Furniture Selection Reference

Space Material FF&E





## BEDROOM2

### Furniture Selection Reference

Space Material FF&E





Light steel house introduction

**PART**  **3**



## The basic structure of a residential system

### 住宅系统的基本构成

具有自重轻、跨度大、抗风抗震性能好，保温隔热、隔声等各项指标卓越的特点，是一种高效、节能、环保、符合可持续发展方针的绿色建筑体系。适用于别墅、多层住宅、度假村、会所等民用建筑、及建筑加层、屋顶平改坡、轻质内隔墙、外围护墙等。安美捷提供预拼装后的出口房屋，墙体包括事先安装好的外墙围护、保温和窗户。屋架系统也可以预拼装的形式供应给客户，与传统的建筑方式相比大大加快了现场安装的时间。

同时，住宅部可为客户提供多种标准的经典别墅设计，也可采用先进的设计软件为客户提供最优设计方案，高效满足客户个性化的需求。

The steel framed housing system has several obvious advantages being light weight, wide span, resistant to strong winds and earthquakes, providing greater thermal comfort and provide excellent noise reduction performance. It is a highly efficient, energy saving, environmentally friendly, sustaining green building system and can be fire rated. It can be used in various residential styles, such as villas, multi-storey buildings, entertainment centers and clubs. It also can be used in adding an extra floor on existing buildings, re-roofing or adding light partitions and external claddings. ANMEIJIE can be exported and wall frames pre-assembled and external claddings, insulation and windows already attached. Trusses can also be supplied Pre-addembled, making installation times significantly quicker than conventional construction methods.

Moreover, BlueScope Lysaght Residential provides many standard classical villa styles. Developers can not only choose from the standard designs, but can also have them customized, if required. Using advanced design software, we will provide the optimized solutions to meet customers' needs with lower cost and high efficiency.



**Residential System Components**  
住宅系统的组成图示

Roof System 屋面系统

Floor System 楼面系统

Wall System 墙面系统

## Product superiorities 产品优势

轻钢结构住宅比普通土木结构住宅，优势表现为：

Comparing with ordinary civil engineering houses, light steel structure houses have such superiorities as follows:

### More flexible 更灵活

轻钢结构住宅提供大共享空间，提高了功能分配的自由度，可以根据需求进行灵活隔断，使室内布置呈多样化；轻钢结构体系能适应任何地质条件，不受地质环境影响，根据需要可以建立在山地、森林、冻土等各种复杂的地上。

Light steel structure houses provide large space for sharing and enhance function distribution that it can be flexibly separated according to specific needs to diversify indoor arrangements. Light steel structure system is suitable for any geological condition that the houses can be built on hilly places, in forests and on frozen earth etc.

### More economical 更经济

轻钢结构体系自重轻，仅为混凝土结构的1/4，可以大大降低建造初期基础费用；轻钢结构住宅设计生产一体化、施工机械化的特点，大大节约了时间和人工；轻薄的墙壁和梁大大提高了住宅的有效使用率。据调查，一栋200平米的二层住宅，轻钢结构住宅的使用面积比混凝土结构住宅多8%—15%，整体综合效益显著。

Light steel structure has light weight. It is only as much as 1/4 weight of concrete structure, which can greatly reduce the cost in initial phase. And the light steel structure houses have the features of integration of design, production and mechanical construction that can greatly save time and space. The light and thin walls and beams improve the utilization rates of houses. It is investigated that for a two-floor house with an area of 200 square meters, the usable floor area of light steel structure houses is 8%-15% more than concrete structure ones.

### Quicker 更快捷

轻钢结构住宅的建造工期短，约为传统结构的1/3左右，所有构件实现工厂预制，现场安装。属于干法施工，不受天气季节影响。平均工期只需要三个月。

The construction time limit of light steel structure houses is short, about 1/3 of traditional ones. All the components are produced in factory and installed on site. The installation way belongs to dry construction that is free from the affects of weather and seasons. The average time is only three months.

### Safer 更安全

轻钢材料优良的物理、力学性能使别墅具备整体刚度大、构件强度高、结构自重轻的特点，在地震、飓风等自然灾害下的表现远远优于其他结构形式，据了解，轻钢结构建筑的抗震性能是普通结构的2倍以上，并可抵抗70M/S的飓风，结构使用更安全可靠。

The excellent physical and mechanical properties of light steel material endow villas with large integrated rigidity, high component strength and light weight. It has good performance in natural disasters such as earth quakes, hurricanes. It is known that the light steel structure has at least twice shock resistance as much as those of ordinary structure and it can resist 70m/s hurricane. The structure is safer and more reliable.

### More durable 更耐久

轻钢结构住宅采用耐腐蚀性强的镀锌钢板、合理的防火构造措施来保证结构的耐久性，无需担心结构在火灾中的严重损坏。所用构件均实行工厂标准化生产，质量稳定，主体结构的耐久性可达70年以上。

Light steel structure houses are made of anti-corrosion zincing steel sheet with reasonable fire proof measurement to ensure the durability of the houses and be free from worries of serious structure damage in fires. All the components are produced in factory under standards with stable quality. The structure of the main body can last for more than 70 years.

### More reassuring 更放心

轻钢结构住宅杜绝了结构徐变、泛潮和遭受白蚁、老鼠等虫害情况，居住更加放心、更加惬意。

The light steel structure is free from creeping, dampness and termite and rats that the living condition are more reassuring and pleasing.

### More comftable 更舒适

轻钢结构住宅采用的高效节能墙体具有呼吸功能，可调节室内湿度，并具有优异的隔音性能，实测结果表明，在室外80分贝（嘈杂音）的情况下，室内仅为40分贝（安静的办公环境）。居住更舒适。

The high efficiency energy saving walls of light steel structure houses have breathing functions that can adjust indoor humidity and have good soundproof ability. It is shown from the results of the experiments that when the sound outdoor is 80 db (noise), the sound indoor is only 40db (quiet for office work). It is more comfortable for living.

### More energy-saving 更节能

轻钢结构住宅的墙体及屋面构造充分考虑了隔热、防潮效果，冬暖夏凉，更能节省大量的能源，数据表明，轻钢集成别墅住宅可提高50%的节能效果，可以节省30%—40%的采暖运行费。

The heat insulation, dampness prevention of the wall and roof structure of light steel structure houses are fully considered in the design that the houses are warm in winter and cool in summer and can save more energy. It is shown from data that the light steel villas can improve 50% energy saving effects and save 30%-50% of heating fees.

### More environmentally protection 更环保

轻钢结构住宅属生态型建筑，采用绿色环保的轻钢作为建筑材料，施工现场文明作业程度高，对环境造成的建筑污染小。房屋钢结构部分可100%的回收，其他配套材料也可大部分回收。

The light steel structure houses belong to ecology type construction that uses green and environment-friendly light steel as building materials. The civilized operation at construction site will cause little pollution to buildings. The steel structure components can be 100% recycled and other auxiliary materials can be mostly recycled.



**Roof System 屋面系统**

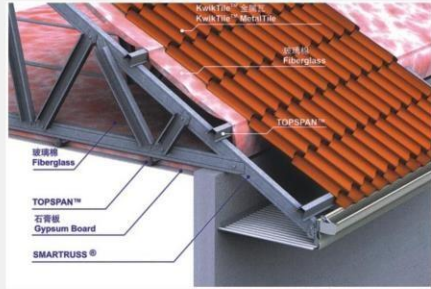

Roofing Type 1 屋面类型1



Roofing Type 2 屋面类型2

**Floor System 楼面系统**

Floor Type 1 楼面类型1

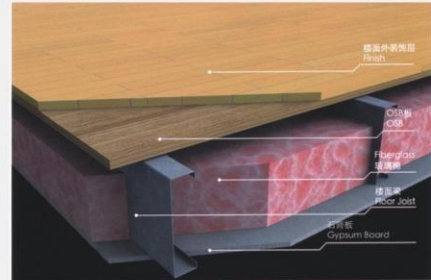

Floor Type 3 楼面类型3

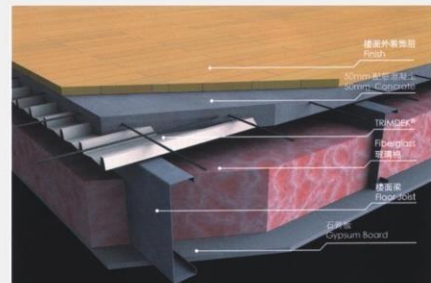

Floor Type 2 楼面类型2

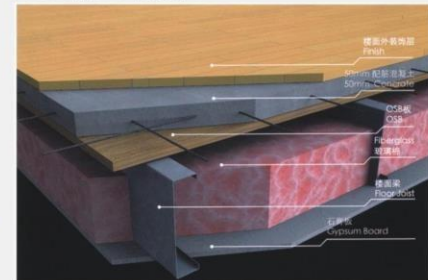

**Wall System 墙面系统**

Exterior Wall Type 1 外墙类型1

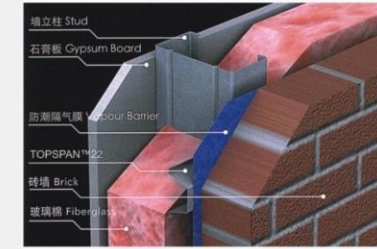

Exterior Wall Type 3 外墙类型3

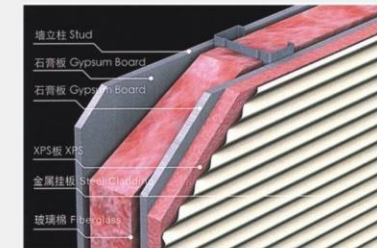

Exterior Wall Type 5 外墙类型5

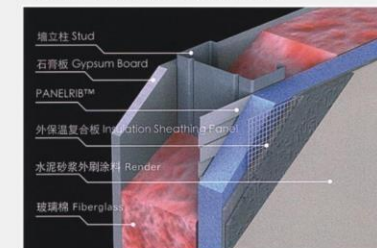

Exterior Wall Type 7 外墙类型7

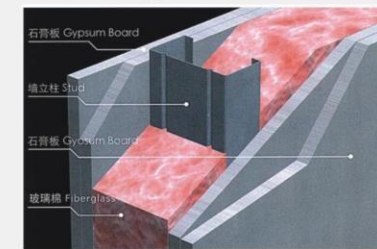

Exterior Wall Type 2 外墙类型2

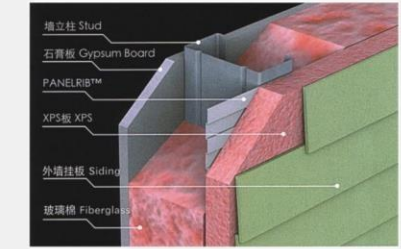

Exterior Wall Type 4 外墙类型4

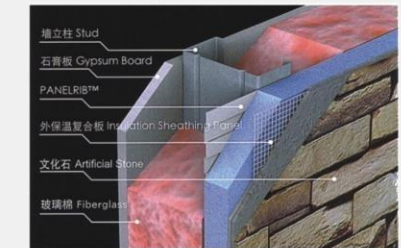

Exterior Wall Type 6 外墙类型6

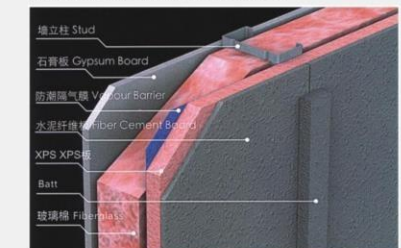

Exterior Wall Type 8 外墙类型8

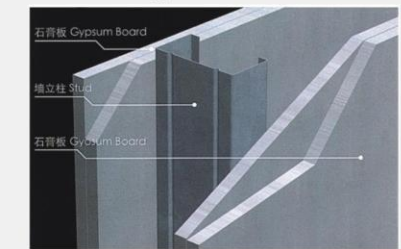



## Project Implementation

considers the needs of customers' orders and strictly implement the in-factory processing and on-site construction according to the national, industry standards and the specific needs of the users.

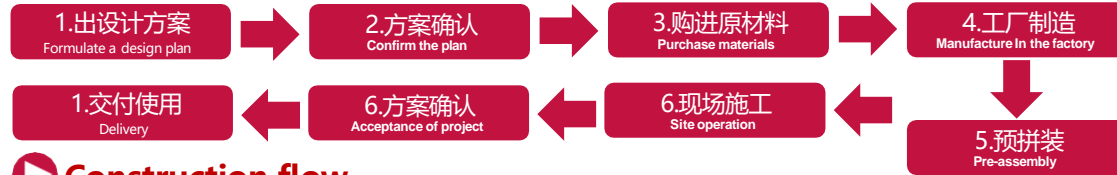

### Construction flow

The Pre-assembled system comes with pre-assembled wall panels and trusses. The pre-assembled walls include anti-dampness paper > insulation, windows, exterior cladding and trim pre-installed to provide the customer time and labor cost saving on site. ANMEDIE panelized system is "NO Waste" package, easy to assemble and quick to complete on any project site, This system is favored by overseas customers. Residential has exported the pre-panelized houses to Australia, Southeast and Africa and so on.



### Installation on site

Provides two types installation systems: panelized and knock Down or 1 stick built\*. Both systems will meet customers\* requirements for fast and easy installation, economical, guaranteed quality. the choice to use either system is project specific.



## Light steel stud

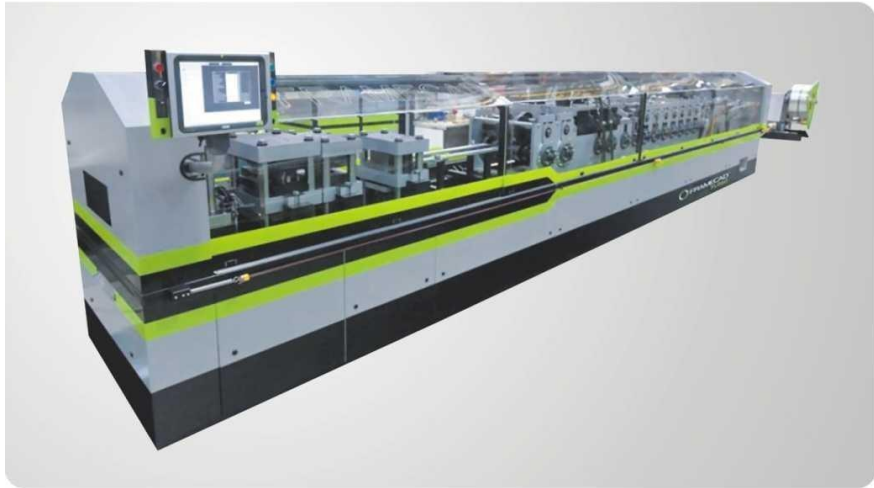

## Certificate and specification



CE Certificate

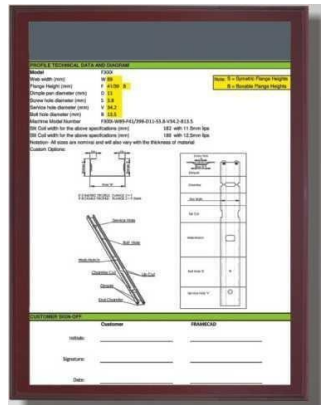

frame cad  
Light Steel  
Dimension

## Production and installation process





## 硅酸钙板介绍

### Calcium silicate plate introduction

#### 防火性能佳

#### Excellent fire performance

Calcium silicate board is A non - combustible material, if there is A fire, the board will not burn, also will not produce toxic smoke.

#### Excellent water resistance

Good waterproof performance, in the bathroom, bathroom and other high humidity place, still can maintain the stability of the performance, will not expand or deformation.

#### Heat insulation

Calcium silicate board has a good thermal insulation performance, 10mm thick partition insulation performance is obviously better than the ordinary brick wall effect and has a very good sound insulation effect.

#### High strength, long service life

The strength of 6mm thick board surpasses 9.5mm thick common paper plasterboard greatly. Not easy to break. Stable performance, acid and alkali resistance, not easy to corrosion, and will not be damaged by moisture or insect ants, can ensure a long service life.



**Color steel tile and its characteristics:**

Caigang watts, is to use color coated steel sheet, cold rolled into a variety of wave type pressure plate, it is suitable for industrial and civil buildings, warehouses, special buildings, large-span steel structure roofing, wall and external decoration of the house, etc., have qualitative light, high strength, color rich, convenient construction, earthquake, fire prevention, waterproof, long service life, maintenance, etc., has been widely applied.

Specific features include the very light weight of colored steel tiles: 10-14 kilograms per square meter, equivalent to 1/30 of a brick wall. Thermal conductivity:  $\leq 0.041w/mk$ . High strength: it can be used as load-bearing plate of ceiling envelope structure, bending and compression resistance; General houses do not use beams and columns. Bright color: no surface decoration, color galvanized steel anticorrosion coating period in 10-15 years. Flexible and fast installation: construction period can be shortened more than 40%. Oxygen index : (OI)32.0 (provincial fire product quality inspection station). Color steel tile size specification.

Color steel tile size 1, yx15-225-900

Pressed steel plate no. Yx15-225-900

Effective coverage width (mm)900

Expand width (mm)1000

Plate thickness (mm)0.5, 0.6

Roof, wall, lining board

Section moment of inertia (cm<sup>4</sup>/m)1.23, 1.48

Section resistance moment (cm<sup>3</sup>/m

Color steel tile size 2. Vertical lock seam 820 roof system pressing plate model RSS820.

Effective coverage width (mm)820

Expand width (mm)1000

Plate thickness (mm)0.5, 0.6

Section moment of inertia (cm<sup>4</sup>/m)22.62, 27.14

Section resistance moment (cm<sup>3</sup>/m)15.06, 18

3. Hidden roof panel yx25-205-820 (taxi-arc)

Pressed steel plate no. Yx25-205-820

Effective coverage width (mm)820

Expand width (mm)1000

Plate thickness (mm)0.5, 0.6

Section moment of inertia (cm<sup>4</sup>/m)4.38, 5.32

Section resistance moment (cm<sup>3</sup>/m)7.18, 8.55

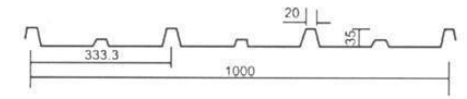
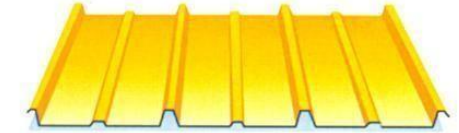

FK35-333, 3-1000 (展开宽度1200)

主要用途: 屋面板 墙面板

有效截面特征	板厚(m m)	0.6	0.8	1.0
Let cm <sup>4</sup> /m		9.53	12.72	15.90
Wet cm <sup>3</sup> /m		14.55	19.11	23.54

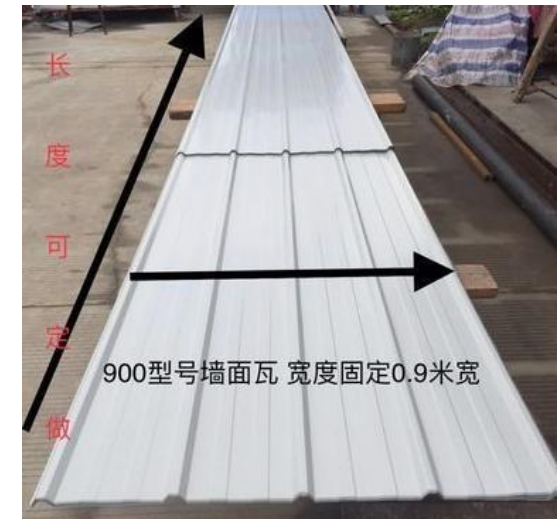



## **Glass wool; mineral wool**

The glass wool adopts the acoustic principle of microporous design. After the sound wave is passed into the microporous tube, it is converted into kinetic energy and dissipated. And glass wool for A class of non-combustible material, it has sound insulation, heat insulation, fire protection, noise reduction performance. Stable chemical properties, long-term use will not appear corrosive problems, ensure the life of the light steel villa.



## Introduction of inner packing materials

The sanitary ware of the toilet adopts the sanitary ware of Guangdong shanggao brand.

Shanggao sanitary ware is a set of bathroom cabinet, ceramic toilet (wash basin), shower room, bathtub, bibcock, shower, hardware accessories and other integral bathroom products r & d, production, sales in one of the modern science and technology sanitary enterprises.

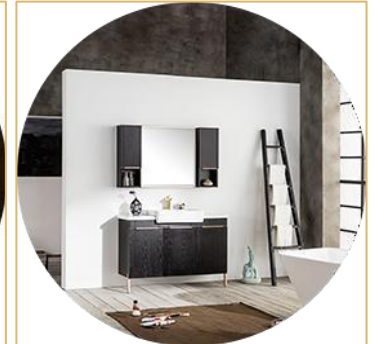
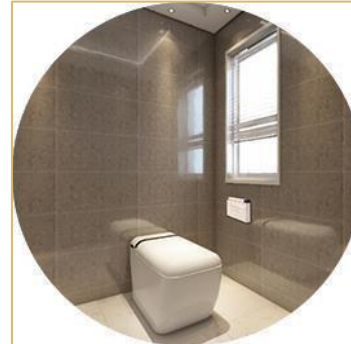
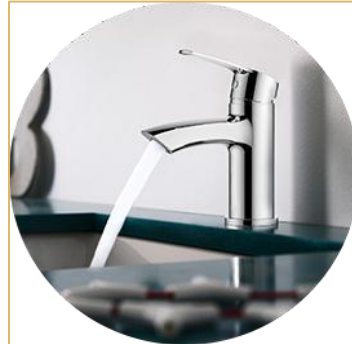



## 内装材料介绍

### 亚克力浴缸+立柱盆

1260°C高温烧制，釉面光滑不黏污，微晶抗污釉面技术，易于清洁，历久弥新。陶瓷吸水率0.2%（国标0.5%），有效防止龟裂。

### 陶瓷马桶

1260°C高温烧制，釉面光滑不黏污，陶瓷吸水率0.2%（国标0.5%），更防臭。裙包管设计易于清洁，快拆式盖板方便日常清洗，科学的管道设计，不返流、不溅水、冲力强。

### 三功能花洒

花洒为高精度低压铸造本体，采用高品质陶瓷阀芯，配360°可旋转下出水口，3档式陶瓷切换阀，1.5m不锈钢软管。

### 洗手盆+洗菜盆水龙头

主体黄铜，低铅环保铜材，进口陶瓷片阀芯，进口陶瓷起泡器，过48小时酸性测试的高标电镀。

## Introduction of inner packing materials

### Acrylic bathtub + column basin

1260°C high temperature firing, glaze smooth and not sticky pollution, anti-fouling technology of microcrystalline glaze, easy to clean, with a long history. Ceramic water absorption rate of 0.2% (national standard 0.5%), effectively prevent cracking.

### Ceramic toilet

1260°C high temperature firing, glaze smooth not sticky pollution, ceramic water absorption rate of 0.2% (national standard 0.5%), more deodorant. Skirt cover design is easy to clean, quick disassembly cover plate is convenient for daily cleaning, scientific pipeline design, no backflow, no splash, strong impact.

### Three function shower

Shower for high precision low pressure casting body, using high quality ceramic spool, with 360° rotatable outlet, 3-speed ceramic switching valve, 1.5m stainless steel hose.

### Sink + sink faucet

Main brass, low lead copper, imported ceramic disc spool, imported ceramic bubbler, high standard plating after 48 hours acid test.





**PART 4**



**澳洲系列 Australia Collection**

单层别墅 Single storey residential

Sydney 88.01m<sup>2</sup>

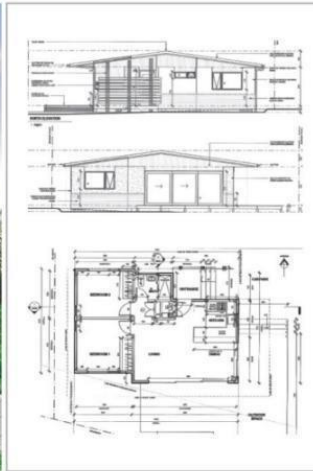

Perth 帕斯 164m<sup>2</sup>

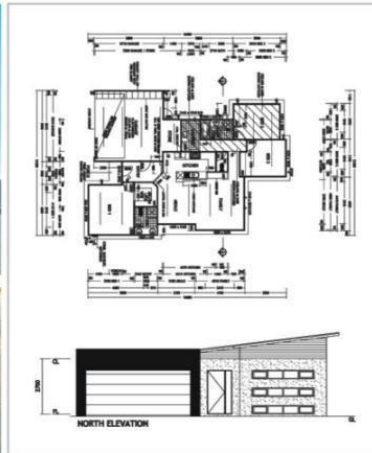

**澳洲系列 Australia Collection**

双层别墅 Double storey residential

Sydney 悉尼 231m<sup>2</sup>

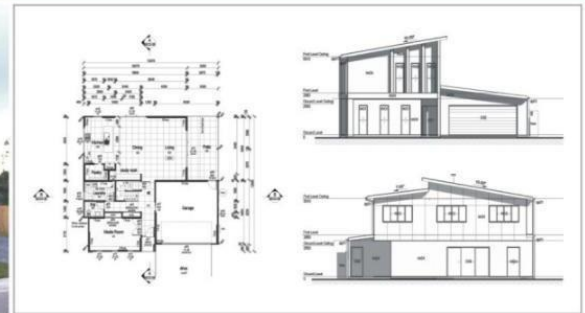
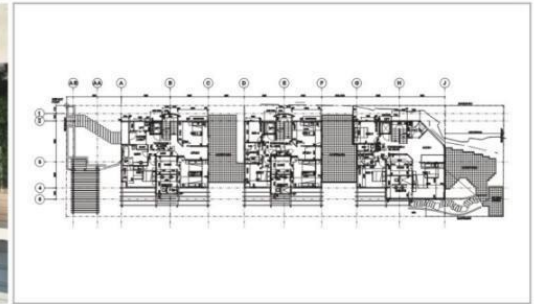

Sydney 悉尼 430.24m<sup>2</sup>



## PNG Collection

PNG 84m<sup>2</sup>

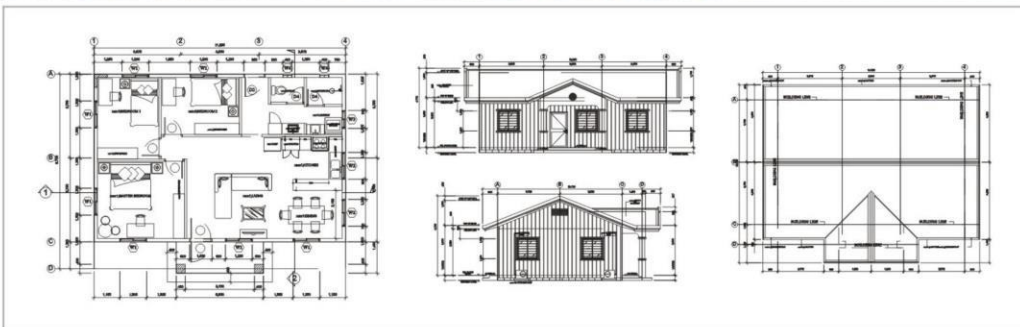

PNG 130.5m<sup>2</sup>

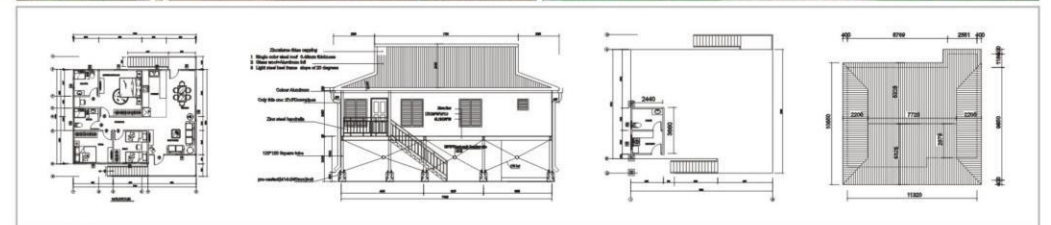

199.87m<sup>2</sup>

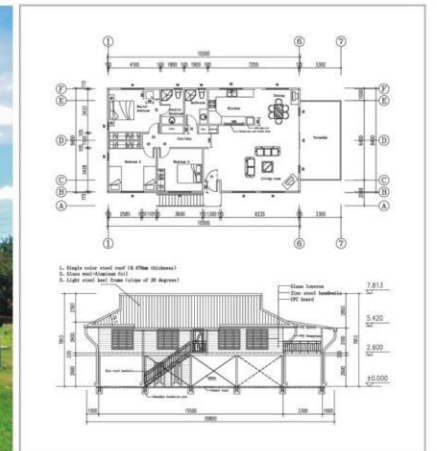



**PNG Collection**

**PNG 84m<sup>2</sup>**



**PNG 828m<sup>2</sup>**

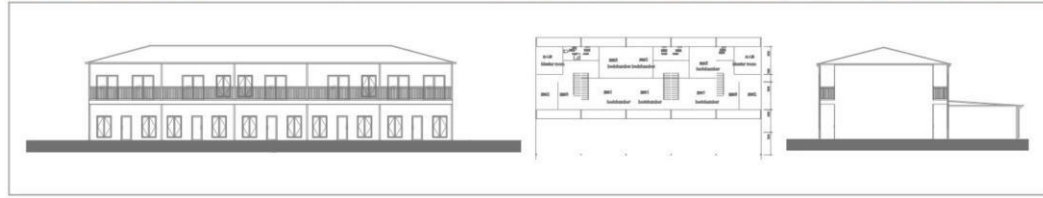

**PNG 862.98m<sup>2</sup>**



**Island collection**

**Maldives 106m<sup>2</sup>**

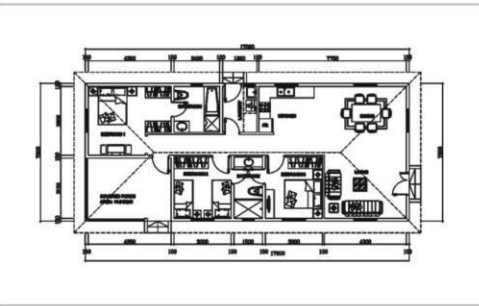



**PNG Collection**

**Maldives 194.3m<sup>2</sup>**



**Guadeloupe 49m<sup>2</sup>**



**Tahiti 148m<sup>2</sup>**



**Venezuela 61.2m<sup>2</sup>**





**Collection**

**Yunnan 24.57m<sup>2</sup>**



**Hainan 195.43m<sup>2</sup>**



**Zhanjiang Petroleum Office 1055m<sup>2</sup>**



**Sanshui 36.75m<sup>2</sup>**





**Xiwangping Village Committe, Beijing 412.32m<sup>2</sup>**



**Aluminum House 90m<sup>2</sup>**



**Low-cost housing 45m<sup>2</sup>**



**High-rise apartment 1865.26m<sup>2</sup>**



**Augola project 104m<sup>2</sup>**





Holiday resort 48-72m<sup>2</sup>



Angola project 96m<sup>2</sup>



Chile project 77.16m<sup>2</sup>



Angola project 280m<sup>2</sup>



Vietnam project 676.94m<sup>2</sup>



Malaysia project 405.65m<sup>2</sup>





## Semi-Detached Residences

Benin projekt 372.14m<sup>2</sup>



Light steel villa 52.09m<sup>2</sup>\*4units



Terraced House 1044m<sup>2</sup>



## Engineering project





## Production Equipment 生产设备

我公司占地面积约为2万5千平方米，拥有各类生产大型钢结构先进设备和生产线，进行严密的生产加工控制，和专业化、规模化的生产制造。

Located in Nanhai Foshan, our company covers about 25,000 square meters. Equipped with various advanced imported equipments for steel structure manufacture, we ensure high production capability and professional solution for our customers. Scientific production management system enables our products to have excellent performance and keep pace with steel structure development in the world.



◉ JZ-400A系列H型钢翼缘矫直机  
Jz-400a Series H Type Steel Flange Straightening Machine



◉ MZG系列MZG-2x1000门型自动埋弧焊机  
Mzg Series Mzg-2x1000 Automatic Submerged Arc Welding Machine



◉ 环保回收设备  
Environmental Friendly and Recycling Equipment



◉ 生产线 Production Line

## Automatic powder Coating line

### 喷涂生产线

本公司拥有珠三角最大重型轨道式全自动喷涂生产线，涂装设备采用德国进口全自动涂装作业技术，挂具单点重量为1000KG,总设计重量为100吨。可加工4吨以下的各种五金重型机械、工程护栏、灯杆、电梯配件、钢构厂房等大型钢结构部件，配电柜等各种五金重型部件，加工尺寸在（长X宽X高）12米X1米X3.7米以内的金属工件。

Our company has the biggest heavy rail-mounted automatic spraying production line in Chu Chiang Delta. The spraying equipment introduces advanced German automatic powder coating operation technology, the single hangs weight is 1000 KG, and the total weight that track can load reaches to 100 tons. We can process various kinds of heavy hardware machinery, engineering guardrail, light pole, elevator accessories, steel structure workshop, distributor box and other large steel structure parts that are less than 4 tons. The processing dimension of hardware accessories is within 12 meters x1 m x3.7 meters(lengthxwidthxheight).





## Installation flowchart 安装流程

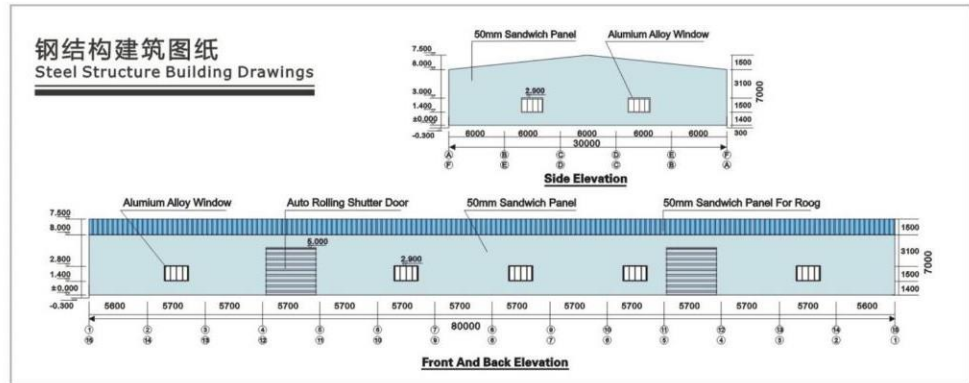

工程名称：利比亚仓库  
NAME OF THE PROJECT: Warehouse—Libya

规格尺寸：38m\*72m\*8m  
Specification: 38m\*72m\*8m

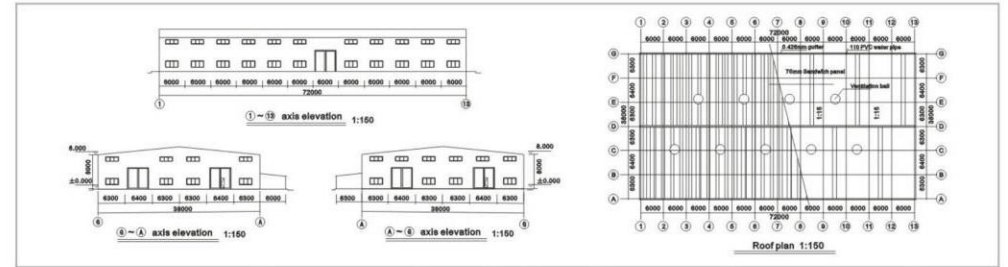

工程名称：肯尼亚厂房  
NAME OF THE PROJECT: Kenya

规格尺寸：3400m<sup>2</sup>  
Specification: 3400m<sup>2</sup>





**工程名称：钢结构物流园仓库**

**NAME OF THE PROJECT: Steel Structure Warehouse Of Logistics Park**

项目规模：33000m<sup>2</sup>  
Project scale: 33000m<sup>2</sup>



**工程名称：摩洛哥弧形仓库**

**NAME OF THE PROJECT: Arch Roof Warehouse—Morocco**

规格尺寸：15m\*42m\*7.2m  
Specification: 15m\*42m\*7.2m

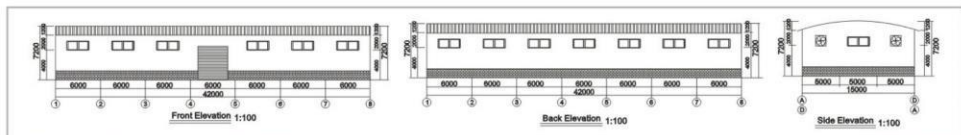

**工程名称：四层宿舍**

**NAME OF THE PROJECT: Four-Storey Dormitory**

规格尺寸：2272m<sup>2</sup>  
Specification: 2272m<sup>2</sup>

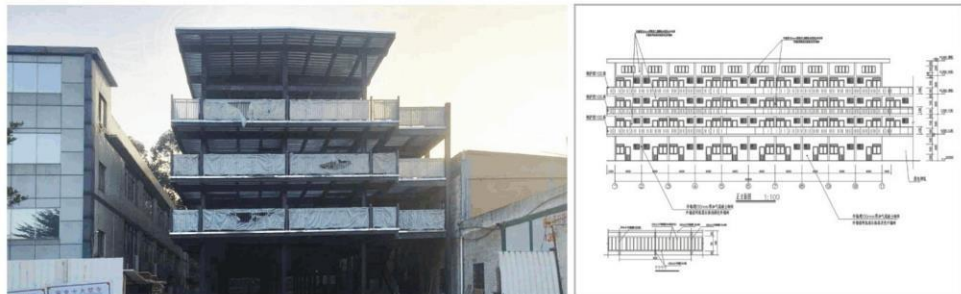

**Light steel frame container house**  
轻钢龙骨厢房

